

| REVISION HISTORY |          |                    |          |
|------------------|----------|--------------------|----------|
| REV              | DATE     | DESCRIPTION        | ECO BY   |
| A                | 10/20/07 | PRODUCTION RELEASE | 11956 AK |

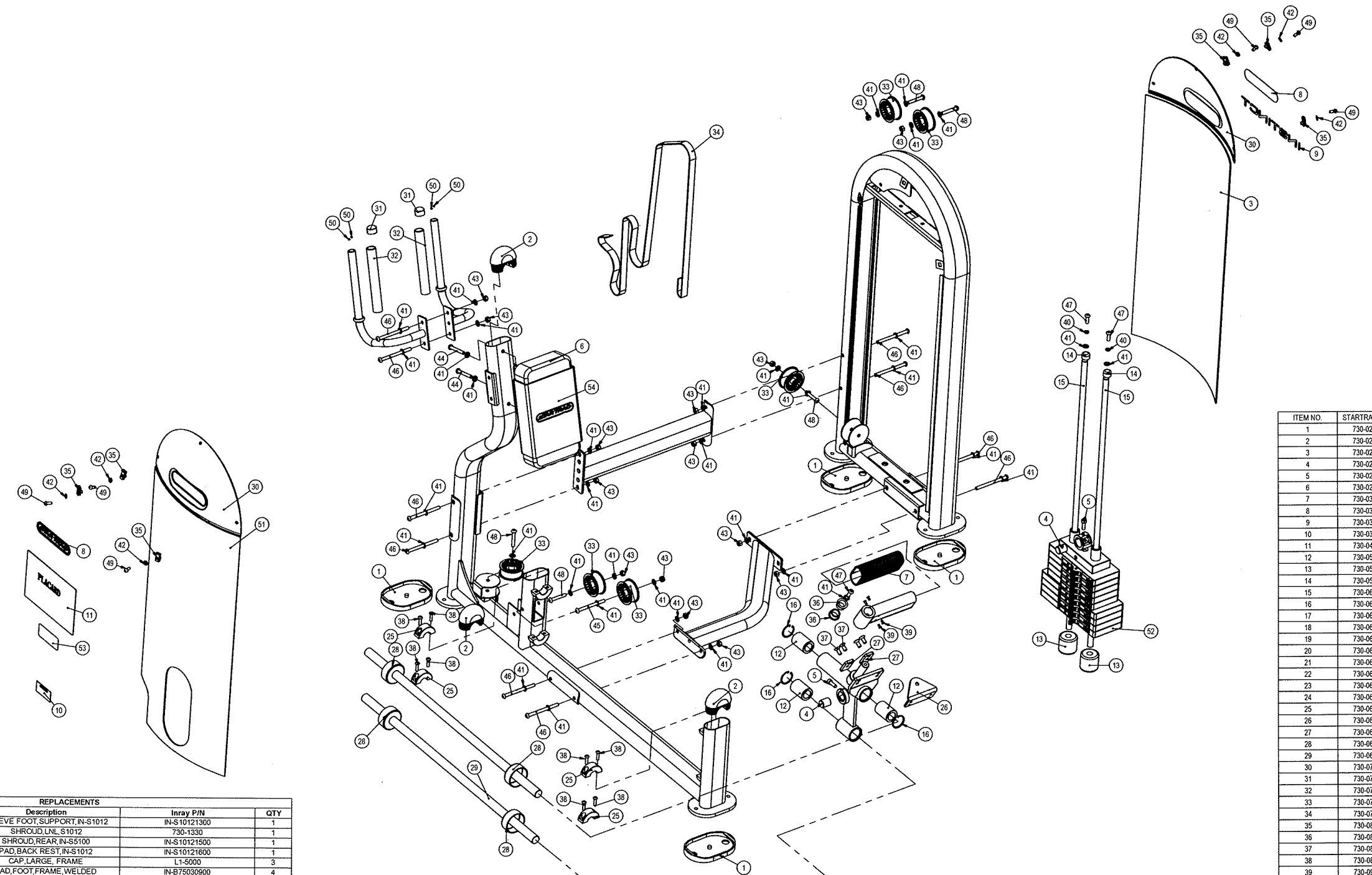

| ITEM NO | STARTRAC P/N | INRAY P/N          | DESCRIPTION                             | QTY. |
|---------|--------------|--------------------|---|------|
| 1       | 730-0216     | IN-B75030900       | PAD, FOOT, FRAME, WELDED                | 4    |
| 2       | 730-0223     | L1-5000            | CAP, LARGE, FRAME                       | 3    |
| 3       | 730-0233     | IN-S10121500       | SHROUD, REAR, IN-S100                   | 1    |
| 4       | 730-0236     | IN-S10121700       | PIN, BELT ANCHOR                        | 2    |
| 5       | 730-0237     | GB70M10-30A2-70NL  | SCREW, M10x30, SHS, SS                  | 2    |
| 6       | 730-0282     | IN-S10121600       | PAD, BACK REST, IN-S1012                | 1    |
| 7       | 730-0312     | IN-S10121300       | SLEEVE FOOT, SUPPORT, IN-S1012          | 1    |
| 8       | 730-0383     | STARTRAC1          | LOGO, STARTRAC                          | 2    |
| 9       | 730-0384     | Instinct           | LOGO, INSTINCT                          | 1    |
| 10      | 730-0385     | CAUTION            | LABEL, CAUTION, PINCH POINT             | 1    |
| 11      | 730-0401     | TZSS1012           | PLACARD, INSTRUCTION, IN-S1012          | 1    |
| 12      | 730-0513     | M30                | BEARING, LINEAR, M30                    | 3    |
| 13      | 730-0562     | IN-D10132900       | BUMPER, STACK, 60MM                     | 2    |
| 14      | 730-0565     | IT80129500         | CAP, END, HANDLE                        | 2    |
| 15      | 730-0662     | IN-S21001300       | WEIGHT STACK, GUIDE RAIL                | 2    |
| 16      | 730-0674     | GB893-147DHS12     | RETAINING, SNAP, RING, 28MM ID, 34MM OD | 3    |
| 17      | 730-0682     | IN-S10120100       | WEIGHT STACK, FRAME                     | 1    |
| 18      | 730-0683     | IN-S10120200       | ASSY, MAIN FRAME                        | 1    |
| 19      | 730-0684     | IN-S10120300       | CROSSBEAM, UPPER, FRAME                 | 1    |
| 20      | 730-0685     | IN-S10120400       | CROSSBEAM, LOWER, FRAME                 | 1    |
| 21      | 730-0686     | IN-S10120500       | FRAME, LEFT, HANDLE                     | 1    |
| 22      | 730-0687     | IN-S10120600       | FRAME, RIGHT, HANDLE                    | 1    |
| 23      | 730-0688     | IN-S10120700       | ASSY, SLIDING, FOOT, FRAME              | 1    |
| 24      | 730-0689     | IN-S10120800       | PRVOT, FOOT, PAD                        | 1    |
| 25      | 730-0690     | IN-S10120900       | GUIDE RAIL, CLAMP                       | 4    |
| 26      | 730-0691     | IN-S10121000       | ASSY, GUIDE, FOOT, COVER                | 1    |
| 27      | 730-0692     | IN-S10121100       | ASSY, FOOT, PIVOT, STOPER               | 2    |
| 28      | 730-0693     | IN-S10121200       | GUIDE RAIL, CLAMP, COVER                | 4    |
| 29      | 730-0699     | IN-S10121800       | ASSY, FOOT, GUIDE RAIL                  | 2    |
| 30      | 730-0702     | IN-D10132800       | SHROUD, UPPER                           | 2    |
| 31      | 730-0704     | IN-B72001200       | CAP, 25MM, ALUMINUM                     | 2    |
| 32      | 730-0705     | IN-S10121900       | FRAME, HANDLE, GRIP, SLEEVE             | 2    |
| 33      | 730-0721     | IN-S51101000       | PULLEY, 75MM                            | 6    |
| 34      | 730-0778     | IN-S10112000       | BELT                                    | 1    |
| 35      | 730-0845     | IN-S21004800       | SHROUD, MOUNTING, U-STYLE, CLIP         | 6    |
| 36      | 730-0858     | M02502000          | BUSHING, 1.0, BRONZE                    | 2    |
| 37      | 730-0870     | CNLM10-25A2-70     | SCREW, M10x25, FHM, HK, SS              | 4    |
| 38      | 730-0891     | GB70M6-30A2-70     | SCREW, M8x30, SHS, SS                   | 8    |
| 39      | 730-0902     | GB819M6-12A2-70    | SCREW, M6x12, FHM, HK, SS               | 4    |
| 40      | 730-0907     | GB9310DG12         | WASHER, M10, SPLIT, LOCK, SS            | 2    |
| 41      | 730-0908     | GB9510A2-70        | WASHER, M10, FLAT, SS                   | 36   |
| 42      | 730-0910     | GB958A2-70         | WASHER, M8, BELLEVILLE, SS              | 6    |
| 43      | 730-1104     | NM10A2-70          | NUT, M10, NYLON PATCH, SS               | 16   |
| 44      | 730-1109     | PNLM10-80A2-70     | SCREW, M10x80, BH, SS                   | 2    |
| 45      | 730-1110     | PNLM10-115A2-70    | SCREW, M10x115, BHC, SS                 | 1    |
| 46      | 730-1112     | PNLM10-130A2-70    | SCREW, M10x130, BH, SS                  | 10   |
| 47      | 730-1118     | PNLM10-30A2-70     | SCREW, M10, BHC, HK, SS                 | 3    |
| 48      | 730-1122     | PNLM10-63A2-70     | SCREW, M10x63, BHC, SS                  | 5    |
| 49      | 730-1138     | PNLM6-20A2-70      | SCREW, M6x20, BHC, SS                   | 6    |
| 50      | 730-1155     | YZGB7710-32x3.2DS2 | SCREW, 10-32x3.2, SET                   | 4    |
| 51      | 730-1330     | 730-1330           | SHROUD, LNL, S1012                      | 1    |
| 52      | 730-1402     | 730-1402           | WSA-LNL, 110LB, 9H                      | 1    |
| 53      | 730-1491     | 730-1491           | LABEL, INSTRUCTIONS, LOCK N LOAD        | 1    |
| 54      | 730-1493     | 730-1493           | HEAD STRAP, IN-S1012                    | 1    |

| REPLACEMENTS |              |  |                    |         |
|--------------|--------------|--|--------------------|---------|
| Item         | StarTrac p/n | Description                            | Inray P/N          | QTY     |
| 7            | 730-0312     | SLEEVE FOOT, SUPPORT, IN-S1012         | IN-S10121300       | 1       |
| 51           | 730-1330     | SHROUD, LNL, S1012                     | 730-1330           | 1       |
| 3            | 730-0233     | SHROUD, REAR, IN-S100                  | IN-S10121500       | 1       |
| 6            | 730-0282     | PAD, BACK REST, IN-S1012               | IN-S10121600       | 1       |
| 2            | 730-0223     | CAP, LARGE, FRAME                      | L1-5000            | 3       |
| 1            | 730-0216     | PAD, FOOT, FRAME, WELDED               | IN-B75030900       | 4       |
|              | 730-0228     | KIT, UPPER SHROUD                      | IN-D10132800       | 1       |
| 30           |              |  | PNLM8*20A2-70      | 3       |
|              |              |  | GB958A2-70         | 3       |
|              |              |  | INLB72001200       | 1       |
| 31           | 730-0151     | ASSY ENDCAP, 25.4MM, ALUM              | YZGB7710-32*3.2DS2 | 2       |
|              |              |  | SLEEVE RUBBER      | 2 FT    |
|              |              |  | IN-S51101000       | 1       |
| 33           | 730-0229     | KIT, PULLEY REPLACEMENT, 76 MM, SINGLE | PNLM10*63A2-70     | 1       |
|              |              |  | NM10A2-70          | 1       |
|              |              |  | GB9510A2-70        | 2       |
| 24           | 730-0328     | KIT, PEDAL ASSY, IN-S1012              | IN-S10120800       | 1       |
|              |              |  | M02502000          | 2       |
|              |              |  | GB819M6*12A2-70    | 4       |
| 34           | 730-0215     | KIT, BELT REPLACEMENT                  | IN-S21002800       | 15.5 FT |
|              |              |  | IN-S10121700       | 2       |
| N/A          | 730-0183     | KIT, HARDWARE, IN-S1012                | GB70M10*30A2-70    | 1       |
|              |              |  | N/A                | N/A     |
|              |              |  | IN-S10120700       | 1       |
|              |              |  | IN-S10121000       | 1       |
|              |              |  | IN-S10121100       | 2       |
|              |              |  | IN-S10121700       | 2       |
|              |              |  | GB893-147FH12      | 3       |
|              |              |  | CNLM10*25A2-70     | 4       |
|              |              |  | GB70M10*30A2-70    | 2       |
|              |              |  | PNLM10*30A2-70     | 3       |
| 29           | 730-0314     | KIT, PARALLEL BARS WELDMENT, IN-S1012  |                    |         |

PRODUCTION DOCUMENT STATUS

THIS DOCUMENT SHALL NOT BE REPRODUCED NOR SHALL THE INFORMATION CONTAINED HEREIN BE USED BY AN INDIVIDUAL TO OTHER EXCEPT AS EXPRESSLY AUTHORIZED BY GANSEN INC. OR A STAR TRAC

| CLASS OF WORK | UNLESS OTHERWISE SPECIFIED TOLLS ARE IN MM. TOLLS ARE FOR MEASURE OF LENGTH USE. |       |       |      |       |      |      | MATERIAL SEE BOM |     |
|---------------|--|-------|-------|------|-------|------|------|------------------|-----|
| FINE          | 0.5  | ±0.05 | ±0.05 | ±0.1 | ±0.15 | ±0.2 | ±0.3 | ±0.5             | --- |
| MEDIUM        | X  | ±0.1  | ±0.1  | ±0.2 | ±0.3  | ±0.5 | ±0.8 | ±1.2             | ±2  |
| COARSE        |  | ±0.2  | ±0.3  | ±0.5 | ±0.8  | ±1.2 | ±2   | ±3               | ±4  |
| VERY COARSE   |  | ---   | ±0.5  | ±1   | ±1.5  | ±2.5 | ±4   | ±6               | ±8  |

FINISH FRAME COLOR: STAR TRAC SILVER (HP FULLER) UPHOLSTERY COLOR: STAR TRAC GREY (SLATE)  
VENDOR: N/A

SCALE: 1:20 SHEET 1 OF 1 SHEET SIZE: B

UNISEN, INC. DBA STAR TRAC 14410 Myford Road Irvine CA 92606

DATE: 10/12/07  
DRAWN: AK  
CHECKED: [Signature]  
APPROVED: [Signature]

REV: 91L-S1012-13BSS A

REV: IN, SSS, GLUTE MACHINE, LNL